

**McCULLOUGH ROBERTSON
LAWYERS FITOUT + SYSTEMS**

Project Location
Level 9, 10, 11 + 12
Central Plaza Two
66 Eagle Street
Brisbane

Client
McCullough Robertson
Lawyers:
Scott Wedgwood

Design
HASSELL Pty Ltd:
Edwina Ewins
Kirsti Simpson
Robert Backhouse
Moirna McNamara
Moby Ng

Project Management
MPS Corporate
Property Services:
Gary Finnegan

Schiavello Vic Fitout
Phillip Ross
Duncan Ramsay
Kevin Crawford

Schiavello Vic Systems
Philip Morgan
Gerrard Sawley
Peter Shumsky

Area
5700 m²

Products
QED desking with QED
perforated +
whiteboard dividing
panels. Systemet metal
storage.

The new fitout for McCullough Robertson supports new ways of working and an emerging culture of collaboration, referencing history and contemporary efficiency.

LAYING OUT THE LAW

The new fitout for the McCullough Robertson law firm is located in one of Brisbane’s premier office towers – Central Plaza Two. The fitout, spanning four floors and 5700 square-metres, was an opportunity to consolidate the firm’s growing operations and more than 300 staff spread over disparate areas.

With a history dating back to 1926, McCullough Robertson has achieved a solid reputation as one of Australia’s most progressive legal businesses. Today McCullough Robertson is recognised as Queensland’s largest independent law firm and as one of BRW’s top 20 law firms Australia-wide [BRW 2005].

Design firm, HASSELL was able to bring to the project all of the benefits of a contemporary legal workplace. The project fitout was managed by MPS working closely with Schiavello’s Qld Fitout and Systems teams. The brief involved a staged handover and complicated two-stage relocation between levels.

“Schiavello’s construction services took a proactive approach towards meeting tight budgetary and time constraints,” says Gary Finnegan, Project Manager for MPS. “They coped well with numerous construction changes and displayed excellent servicing skills.”

Schiavello’s fitout team was charged with a complete demolition of the existing fitout, making good works and construction of the new workspace, featuring an expansive reception area, internal stair linking the four floors, vivid breakout areas on all levels and the impressive ‘village green’ entertainment area to encourage interaction.

Anticipating strong growth, flexibility was paramount. Back of house areas articulate a highly efficient, ordered and utilitarian workplace with a sense of fun, enhanced by Schiavello’s QED freestanding workstations with perforated metal faced screens to support staff in open areas and fixed QED desks to offices.

Front of house areas exhibit a sense of timelessness. HASSELL’s Edwina Ewins says an extensive use of natural materials forms the basis of the external perception of the firm. Luxury mixes with utilitarianism. The blend of bronze mesh with white laminate appropriately references both history and contemporary efficiency. The planning is regular and efficient and does not represent a hierarchy.

“The fitout essentially captures the feeling of the ‘old’ McCullough Robertson, a place where people interact freely, share work and social experiences and genuinely enjoy working with one another, and the design succeeds in reflecting our firm and its values,” comments Scott Wedgwood, Partner, McCullough Robertson.



1

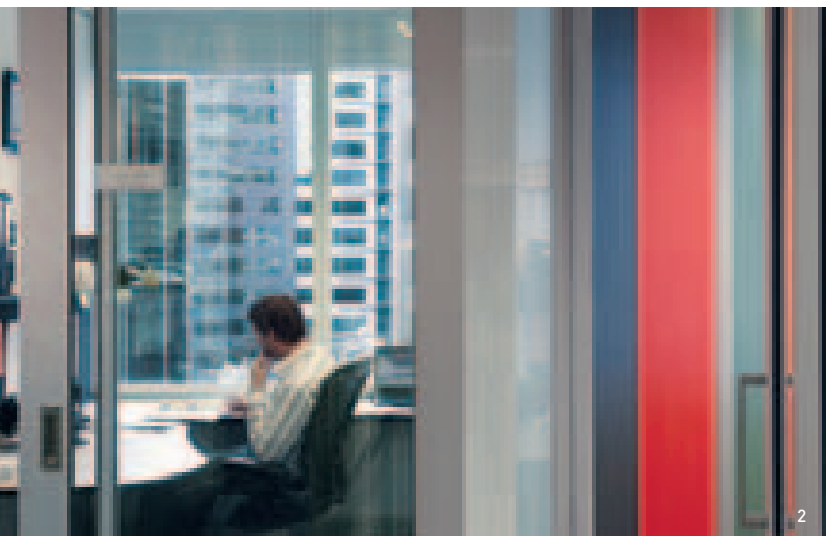

2

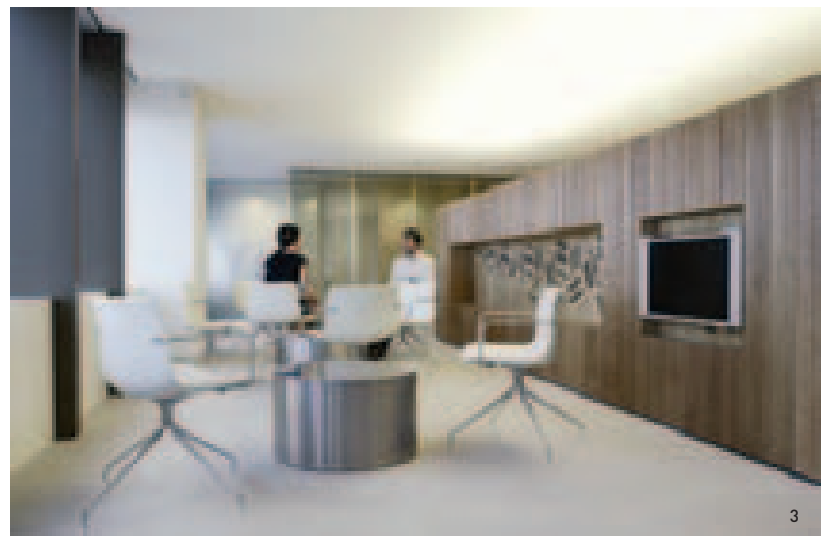

3

- 1_ A welcoming reception.
 2_ Office area featuring Schiavello's QED work environment
 3_ An open interconnecting stair arrives on each floor at the breakout zone.