



Workplace Fitouts

Creating Spaces

The workplace is an evolving environment that fosters culture, productivity, and meaningful team interactions.

Whether you're considering setting up a new office, expanding or upgrading your existing premises, be inspired by the amazing workplaces we at Schiavello Construction have had the pleasure of creating.

Step inside.



PLANNING YOUR WORKPLACE FITOUT

- 06** Your project partner
- 07** Design and construction journey
- 08** Understanding your change drivers
- 09** Creating meaningful spaces

EXPLORING PROJECTS

- 11** Reece
- 15** Microsoft Technology Centre
- 21** Aurecon
- 23** CBUS
- 27** 7-Eleven
- 31** Space&Co
- 35** DEWNR
- 39** Dentsu Aegis Network

WORKING TOGETHER

- 43** Services
- 45** Contact us

As you prepare for this journey, you may like to keep in mind a philosophy that's been the driving force of our business. In the words of our founder, Tony Schiavello, "Anything is possible". Allow this to motivate you to open up a world of endless possibilities.

“

Anything
is Possible.



Your Project Partner



For Schiavello Construction, the workplace is where it all began. It's a space we know well, and one we have dedicated over half a century to better understand, create, and service.

As a leading workplace fitout specialist in Australia, we pride ourselves on delivering over 1,000 quality spaces that embody both an aspirational and functional vision.

We take pride in partnerships that create unique places of value for our clients.



Design and Construction Journey

Collaboration is key to uncovering what you want to achieve and ultimately bringing your vision to life. We'll work with you through the design and construction stages of your workplace fitout.

01

Think

Understanding the vision and key drivers for your workplace facilitates a design that is purposeful for employees and customers.

02

Design

Together, we transform your vision into a design that factors in both aspirational and functional perspectives.

03

Construct

It's time to bring your plans to life. The fitout commences with a clear understanding of the design intent and is project managed within the specified timeframe and budget.

04

Move

Whilst you move into your new workplace, all relevant information and training for the use of equipment and facilities are provided. We remain available to provide any additional support you may require.

Design with Purpose



Change Drivers

An office change can be driven by multiple reasons. Understanding these reasons helps your organisation future-proof its workplace.



New

- Establishing a new company
- Moving to a new office location

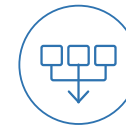

Consolidation

- Bringing multiple offices to one location
- Downsizing the office space



Expansion

- Preparing space for growth
- Adding additional facilities



Upgrade

- Redesigning the space
- Refreshing the look and feel
- Enhancing technology or facilities

Meaningful Spaces

Creating meaningful spaces within your workplace has a positive impact on the wellness, productivity, and experience of your employees. Here are design and built solutions to consider:

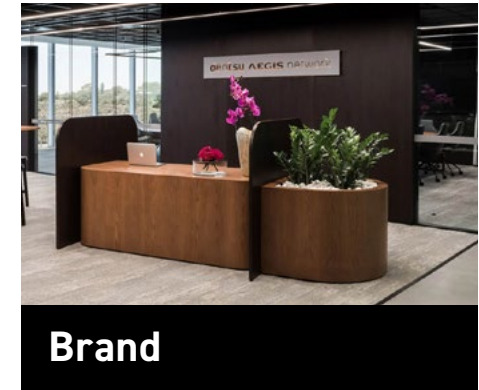
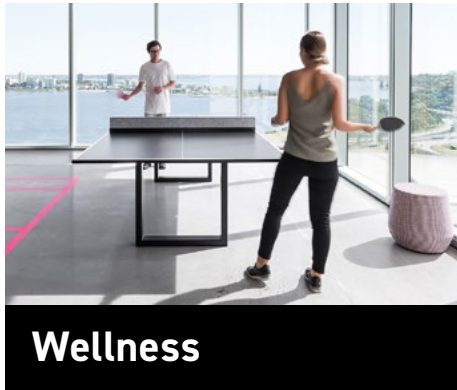

Health & fitness



- On-site gym or yoga studio
- Sit-stand furniture and meeting tables
- Ergonomic workstations
- Wellbeing area
- End-of-trip facilities
- Games room

Connection to outdoors



- Alfresco area
- Indoor plants
- Natural lighting

Inclusivity



- Parent facilities
- Prayer rooms

Adaptable workspaces



- Quiet nooks, phone booths
- Individual spaces, focus rooms
- Huddle rooms, project rooms
- Modular, adaptable joinery

Collaboration



- Inspirational spaces
- Collaboration spaces

Connection



- Open lounges
- Interconnected stairs

Digitisation



- Integrated technology
- In-built AV equipment
- AI technology

Sustainability



- Durable joinery and furniture
- Recycled and recyclable materials
- Natural insulation

Employee and visitor experience



- Welcoming foyer or reception
- Easy to navigate layout
- Brand aligned look and feel

Explore the Possibilities

PLUMBING

Reece

A workplace centred on every aspect
of employee wellbeing, digitisation,
sustainability and aesthetics.

[View entire project](#) ✨

57 Balmain Rd, Richmond | 7,400sqm





OBJECTIVE

Relocate 400 employees from Burwood to Cremorne to align with the company's future vision.

CHANGE DRIVERS



Moving to a new office location

DESIGN & BUILD SOLUTIONS



Digitisation

Activity based working areas – focus booths, phone booths, informal and formal meeting spaces including high tech board rooms with state-of-the-art AV equipment built in and acoustic panelling.



Health and fitness

Technology enabled water fountains to allow employees to track their water intake. Yoga studio and EOT facilities.



Inclusivity

Parent rooms and prayer facilities.



Connection to outdoors

Outdoor alfresco terraces with greenery and indoor plants throughout the build.





TECHNOLOGY

Microsoft Technology Centre

An innovative technology hub inspiring
the future of business.

[View entire project](#) 

1 Martin Place, Sydney | 1,680sqm





OBJECTIVE

Create an innovative futuristic space reflective of Microsoft's leadership in the world of tech.

CHANGE DRIVERS



Establishing a new company



Upgrading the space and facilities

DESIGN & BUILD SOLUTIONS



Inspirational spaces

Experiential fitout which demonstrates the digital transformation possibilities for businesses, students and government.



Digitisation

Leading by example in the tech arena with an envisioning theatre, innovation lab, cyber security room, and a customer workshop area.



Employee and visitor experience

Vibrant colours and cutting-edge building processes create office spaces and a showroom that feel more like a luxe hospitality venue.





ENGINEERING

Aurecon

A functional open-plan workplace
with a refined sense of quality and
conscious design.

[View entire project](#) 

25 Grenfell Street, Adelaide | 2,700sqm





OBJECTIVE

Provide a facility future-proofed for the next 10 years with a particular emphasis on flexibility in day-to-day operations.

CHANGE DRIVERS



Preparing space for growth



Moving to a new office location

DESIGN & BUILD SOLUTIONS



Adaptable workspaces

A variety of multi-purpose facilities such as breakout areas, large boardrooms and impromptu meeting spaces featuring modular loose furniture for the ultimate flexibility.



Collaboration

Largely open-plan office working areas across three floors, all interconnected by a stunning timber staircase which was 3D modelled for precision prior to its construction.



Employee and visitor experience

Timber featured in many forms and applications – stair treads, ceiling, joinery, and decorative battens - to create a sense of warmth and timelessness that will last for the 10-year lease.

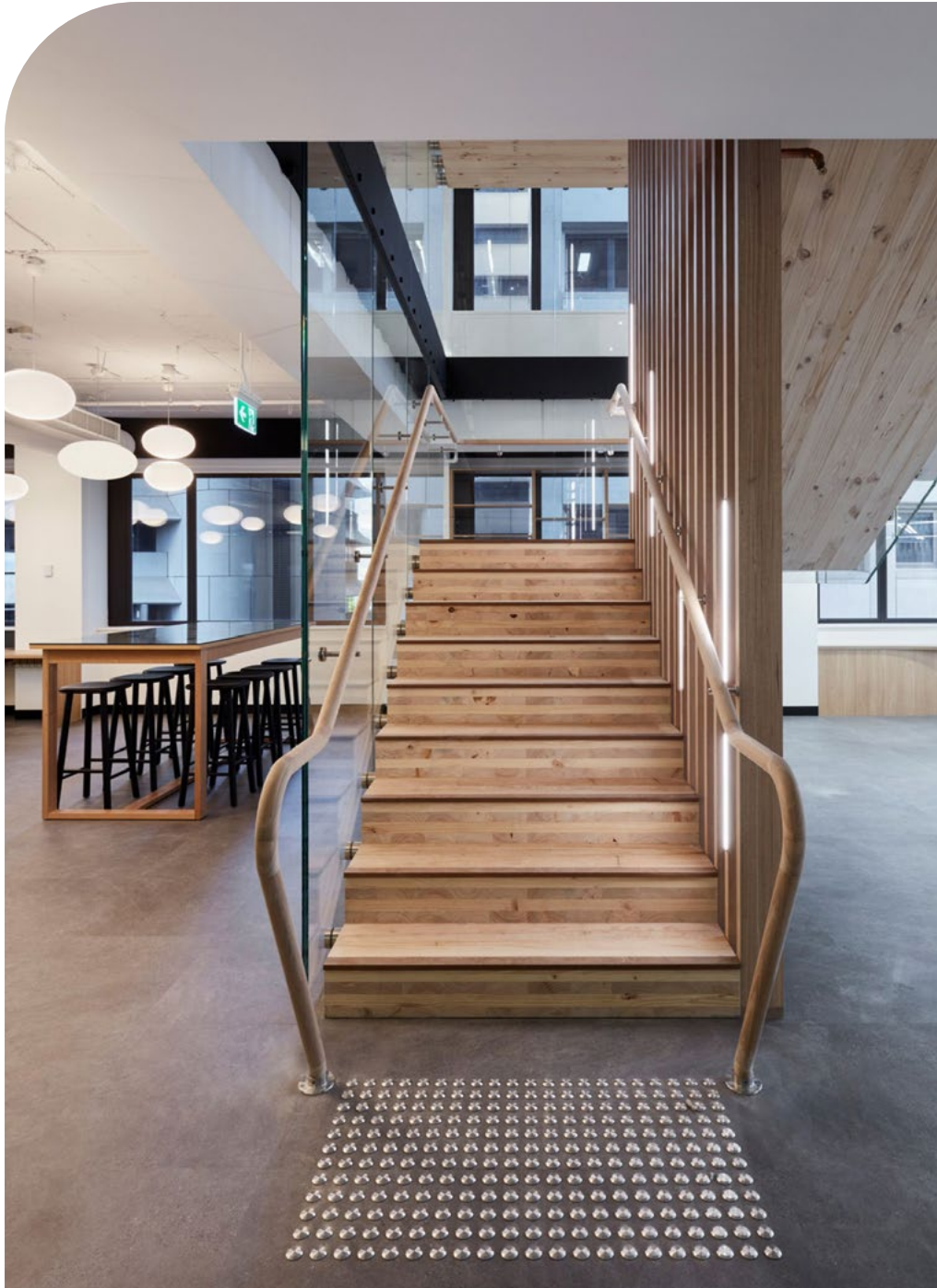

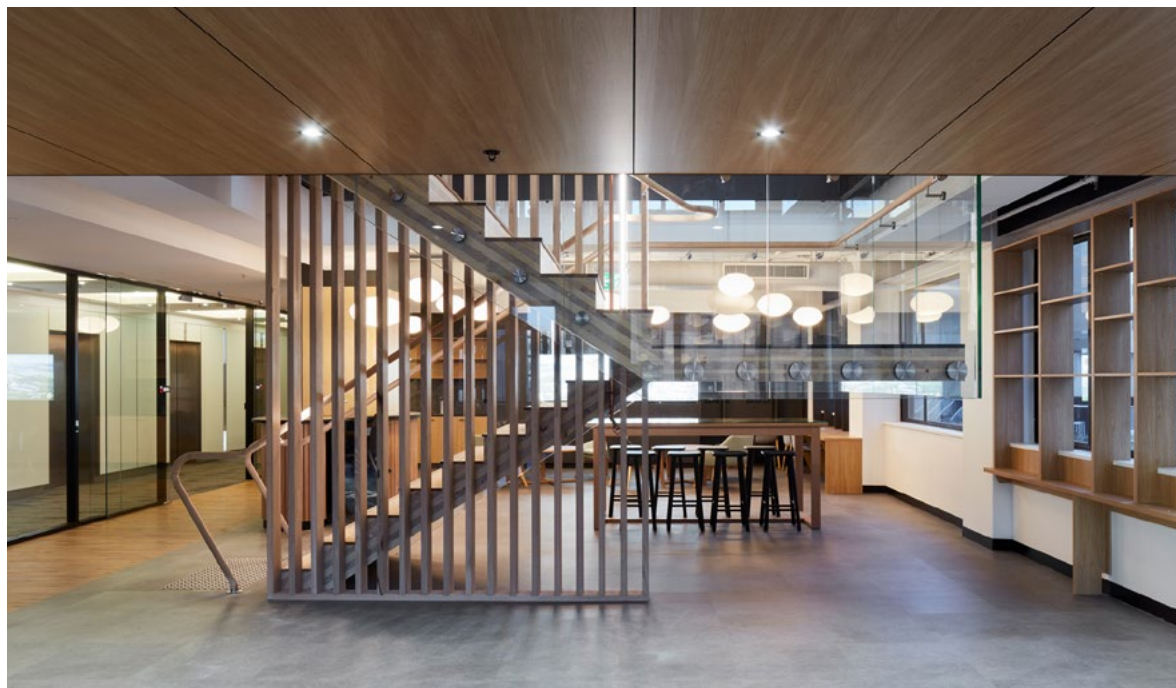
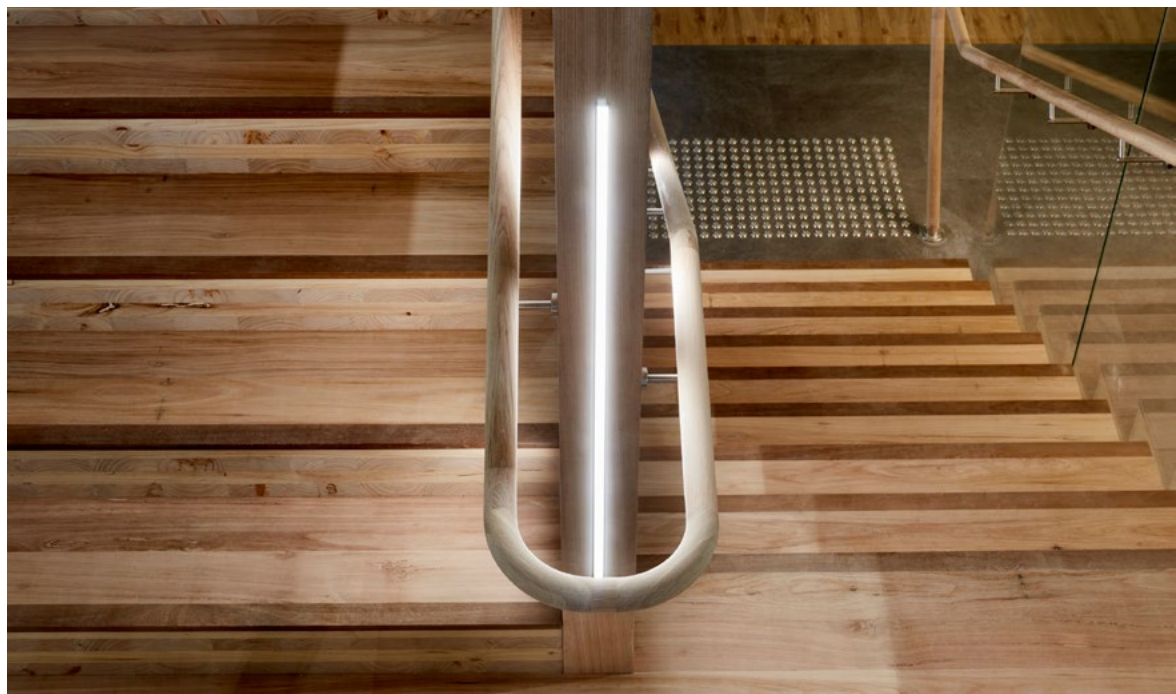

INDUSTRY SUPER FUND

CBUS

Dynamic workspaces allowing employees to focus on achieving the best investor outcomes together.

[View entire project](#) ✨

130 Lonsdale Street, Melbourne | 9,200sqm

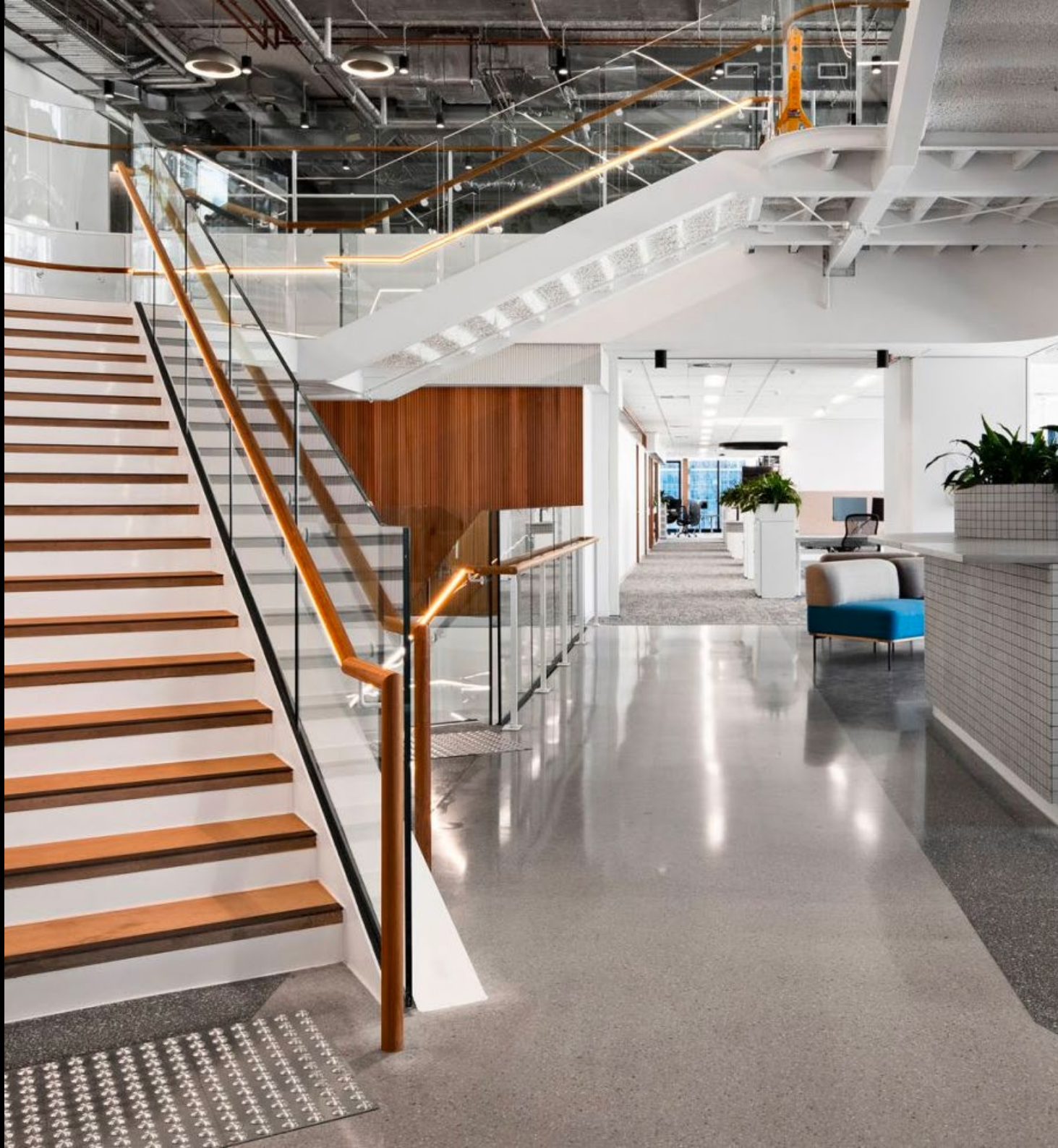



OBJECTIVE

Set up a new headquarters to facilitate the company's expansion and need for easier collaboration with added privacy.

CHANGE DRIVERS



Preparing space for growth



Moving to a new office location

DESIGN & BUILD SOLUTIONS



Adaptable workspaces

Open-plan workplace with an array of collaborative spaces, quiet focus areas, meeting rooms, as well as dedicated corporate and member areas.



Digitisation

Convenient and consistent AV technology across all meeting rooms for improved collaboration and user experience.



Employee and visitor experience

High acoustic ratings achieved through acoustic ceilings, barriers, and insulation with meeting rooms acoustically treated and tested to exceed the standard.





RETAIL

7-Eleven

A unified corporate office
grounded in community,
collaboration, and connectedness.

[View entire project](#) 

658 Church Street, Richmond | 6,846sqm

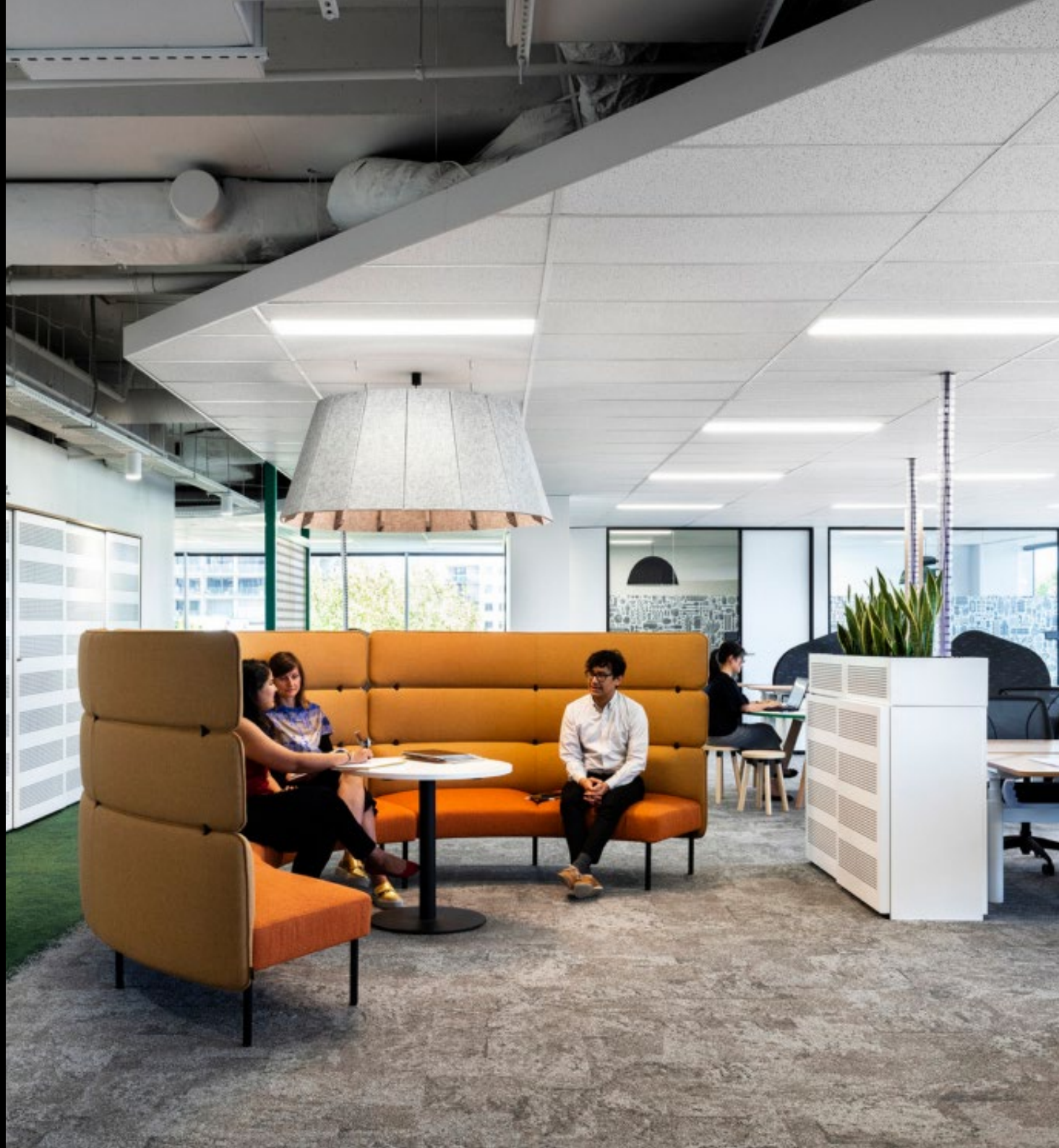



OBJECTIVE

Consolidate 500 staff members across three companies from various locations under one roof in Richmond.

CHANGE DRIVERS



Bringing multiple offices to one location



Moving to a new office location

DESIGN & BUILD SOLUTIONS



Adaptable workspaces

Focus, touchdown, and breakout spaces – each with varying degrees of visual and acoustic privacy – allow employees the freedom to choose a workstyle that suits them.



Collaboration

Collaborative areas featuring adaptable furniture to support flexible working styles.



Connection

Existing staircase enlarged and refurbished to encourage free movement between levels and offer a greater sense of community.



Employee experience

Intelligent layout with workstations placed along the windows to allow access to natural light for all.



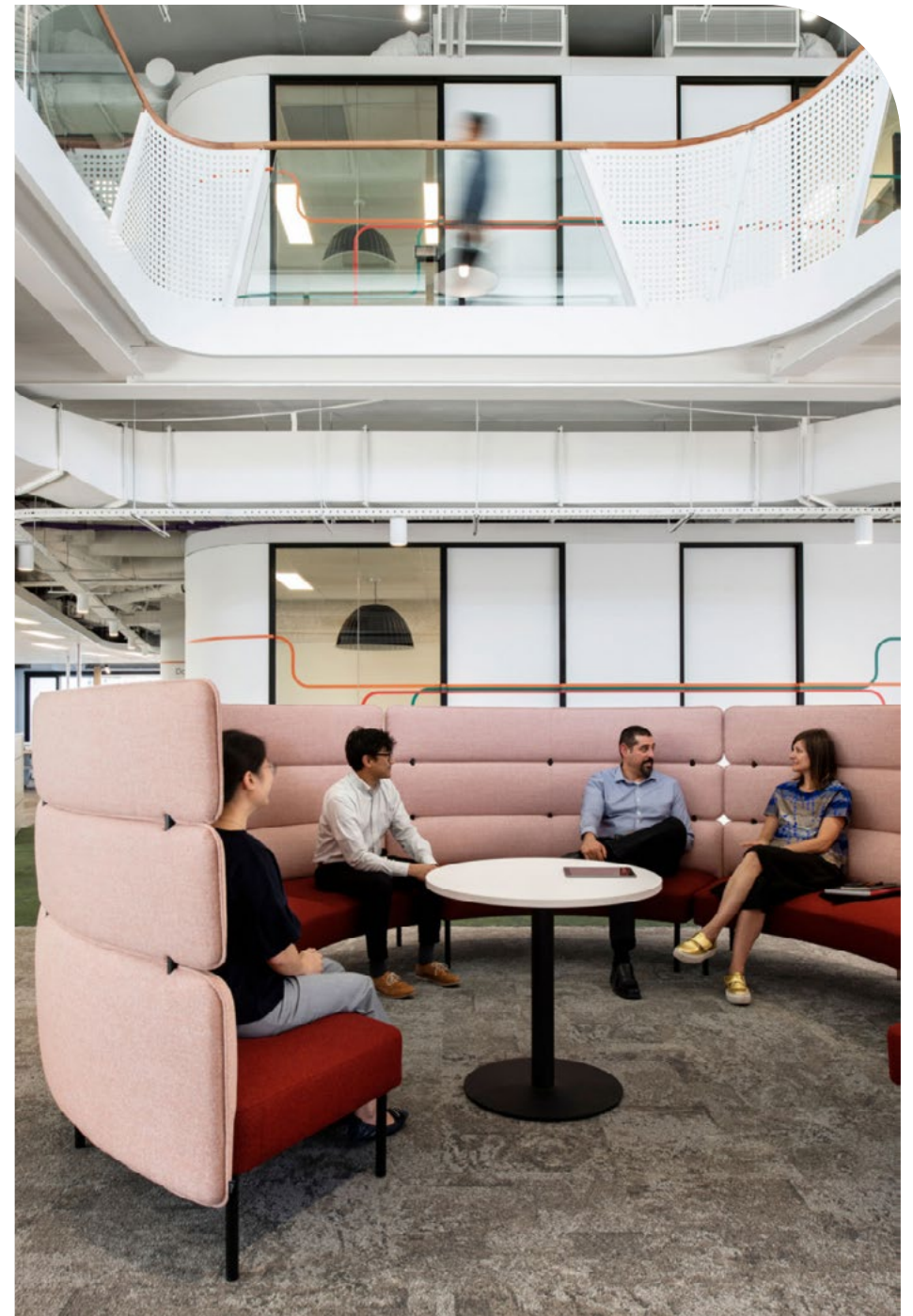

CO-WORKING SPACE

Space&Co

Upping the ante for co-working spaces
has set a new benchmark in quality
and innovation.

[View entire project](#) 

580 George Street, Sydney | 1,224sqm





OBJECTIVE

Create a stunning yet functional and highly collaborative environment for individuals and organisations to make use of alongside each other.

CHANGE DRIVERS



Moving to a new office location

DESIGN & BUILD SOLUTIONS



Digitisation

Technological features plus a variety of spaces allow startups to innovate and grow, and established organisations to thrive.



Employee and visitor experience

Space&Co's iconic 'Glasshouse' sitting proudly atop elevated timber flooring provides a minimalistic meeting room with personality.



Look and feel

Rustic finishes – glass, natural timbers, steel, and polished concrete – makes for an inspirational and calming space.

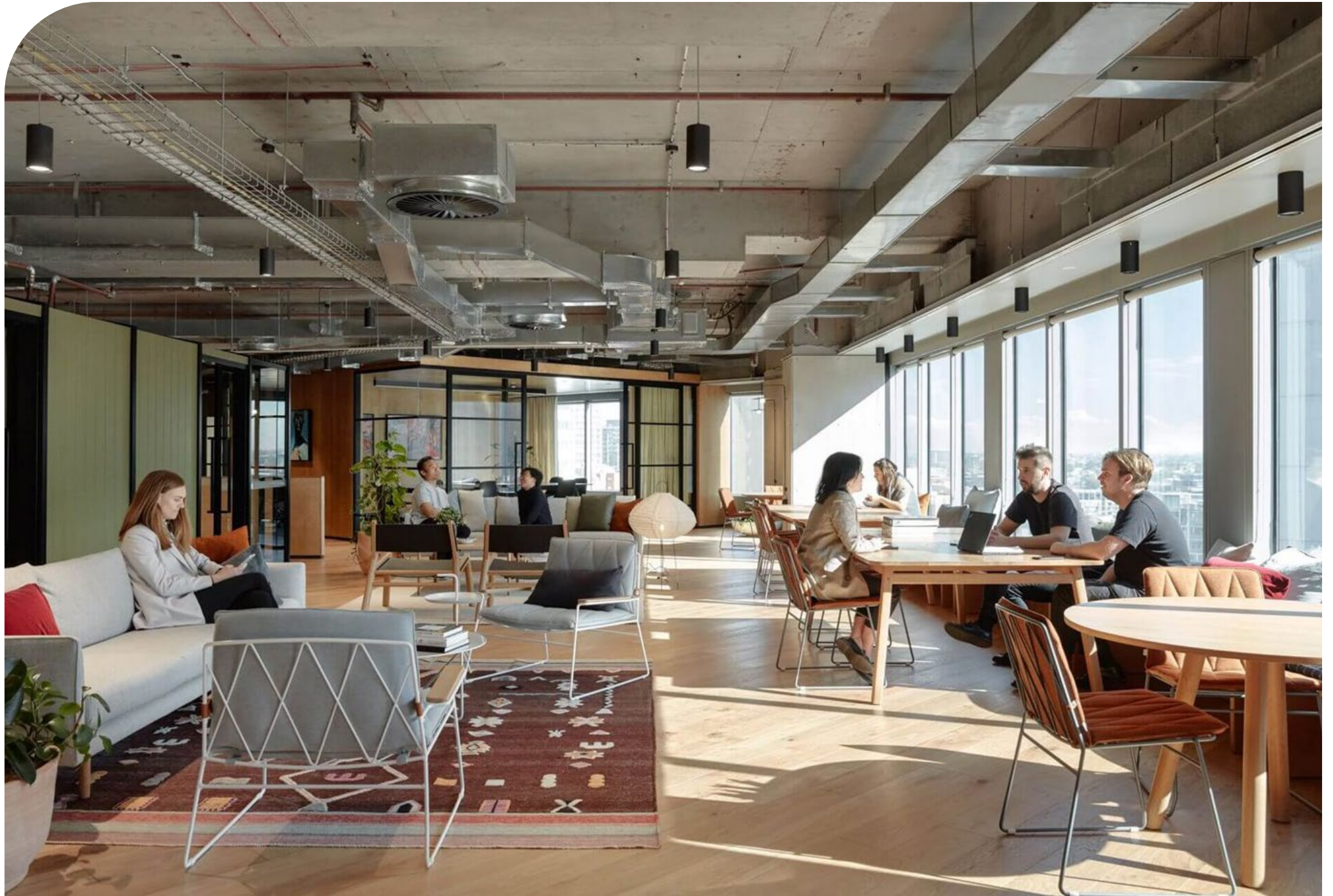



GOVERNMENT

DEWNR

Government department for Energy, Water and Natural Resources sets the standard with an award winning sustainable and innovative work environment.

[View entire project](#) ✎

81-91 Waymouth Street, Adelaide | 15,000sqm





OBJECTIVE

Unite 900 employees across seven locations to a central location which demonstrates industry leading sustainability and budget management.

CHANGE DRIVERS



Bringing multiple offices to one location



Moving to a new office location

DESIGN & BUILD SOLUTIONS



Sustainability

GBCA 6-star Green Star rating under Design & Construct model boasting energy efficiency, building life cycles, and recycling to the highest standards. A remarkable 90.4 percent of waste was recycled during construction.



Cost saving

Seven separate metro locations combined into one, saving \$30m in lease fees over 12 years.



Connection to outdoors

Optimal occupant comfort thanks to clean air, natural light, and indoor living greenery.



Health and fitness

Provision of end of trip facilities for 30% of all staff - well above the average - including 264 secure bicycle racks plus showers, change rooms, and lockers.





MEDIA

Dentsu Aegis Network

A cutting-edge urban office space designed with workplace culture and agility top of mind.

[View entire project](#) ✎

Brookfield Place, Tower 2 L14, George Terrace,
Perth | 1,000sqm



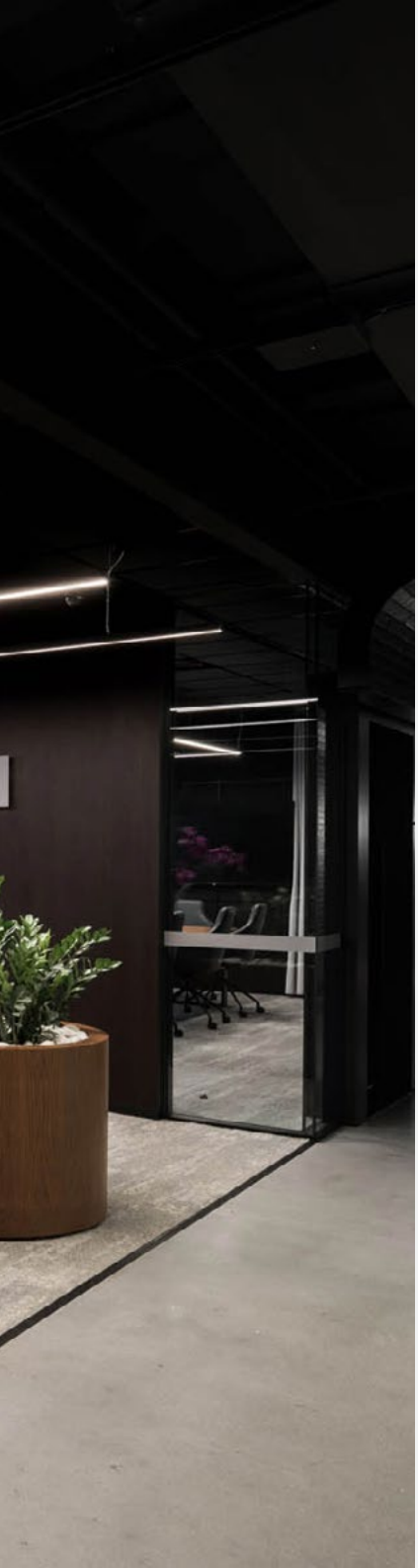

OBJECTIVE

Debut in Perth with an office designed to enhance workplace culture and facilitate flexibility and collaboration.

CHANGE DRIVERS



Moving to a new office location

DESIGN & BUILD SOLUTIONS



Collaboration

Casual breakout area with a breakfast bar offers a relaxed environment and alternative collaboration space.



Adaptive workspaces

Dedicated formal and informal meeting spaces, focus rooms, phone booths and "swarm spaces".



Visitor experience

Custom front of house ceiling is characterised by black metal mesh tiles with acoustic felt paneling.



Health and fitness

A super-scale neon basketball court suspended from the exposed slab and mirrored on the floor, sets the backdrop for a ping pong table.



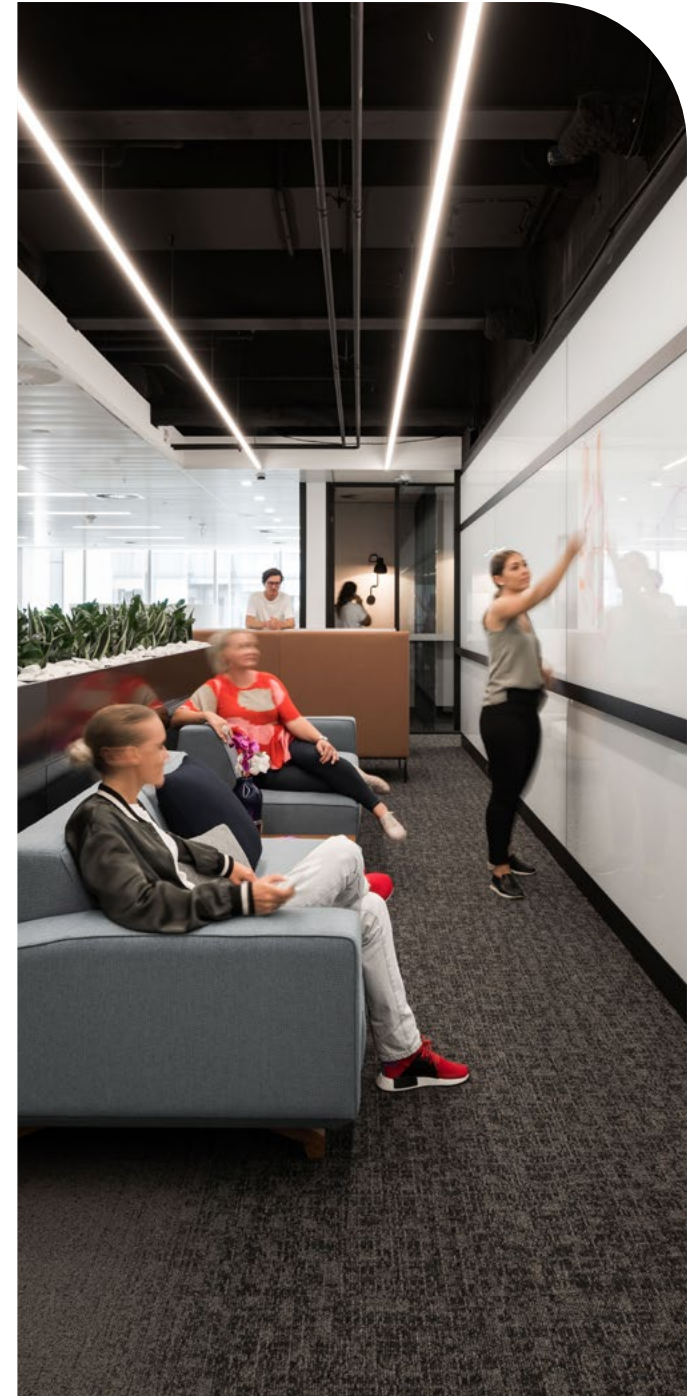

Services

Schiavello Construction is a leading construction, fitout and refurbishment company born out of an entrepreneurial spirit and can-do attitude. With over 55 years of experience delivering exceptional projects across Australia, our lasting commitment to our clients is to go above and beyond.

In addition to our construction services, Schiavello offer an array of products and services from furniture, workspace utilisation technology through to the manufacturing of joinery, glass, and bathroom products.



SCHIAVELLO CONSTRUCTION

A national network of 150+ highly skilled experts specialising in project and construction management, design management, contract administration, site management, specialty trades, and quality assurance.



SCHIAVELLO FURNITURE

Through decades of research and knowledge, furniture solutions are designed and created for workplaces, healthcare, government hospitality, retail, and residential sectors.



PRIMA ARCHITECTURAL JOINERY

Highly skilled joinery and cabinet maker specialising in detailed custom joinery for workplace, retail, hospitality, healthcare, and residential projects.



NURA SPACE

A digital Unified Working Platform (UWP) designed to intuitively support, understand and optimise workspaces and how people use them. Leveraging IoT, data and behavioural science, Nura Space allows employers and their teams to curate a working experience centred on wellbeing, safety and efficiency.

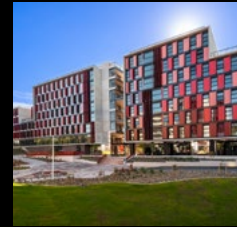

HERITAGE GLASS

Specialises in the design, supply, installation and certification of glass and aluminium for commercial and residential building projects.



MANUFACTURING

With world-class manufacturing facilities located in Melbourne, our specialised services include engineering and tooling, metal, aluminum and wood processing, plastic injection moulding, electrical component production, powder coating, glass processing, upholstery, solid surface fabrication and assembly operations.

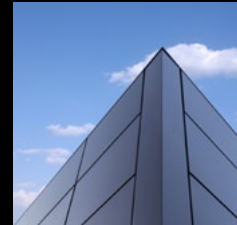

KERTN

Integrating efficient and economical architectural prefabricated modular façade systems using the AZURE® Façade System. Suitable for a wide range of façade applications.



GLASSWORKS

An Australian glass manufacturer servicing the building industry with the most energy-efficient windows and unique decorative glass products.



OMVIVO

A pioneer in contemporary bathroom product design and manufacturing for over 25 years, consistently remaining at the forefront of the Australian and international bathroom market.

A photograph of three men in an office setting, smiling and looking at architectural plans on a table. The man on the left is wearing a blue shirt, the middle man a plaid shirt, and the right man a white shirt. They are all holding pencils. The background is slightly blurred, showing office equipment and plants.

Let's collaborate

Work with a team that's highly experienced in workplace fitouts.
Fill in our online enquiry form or call one of our local offices to
discuss your project.

Online enquiry form 

VIC & TAS

1 Sharps Road
Tullamarine VIC 3043
(03) 9330 8888

NSW, ACT & QLD

Level 5, 241
Commonwealth Street
Surry Hills NSW 2010
(02) 9213 1500

SA

14 Gilles Arcade
Adelaide SA 5000
(08) 8112 2300

schiaavello
construction