

Lettric Technology Column



technical



120° Lettric Technology Column

Accessible power, data and communications delivery via a space efficient, highly functional triangular structure.

Index

- workstation cluster **02**
- panel to tech column junction **02**
- suspended tech columns **03**
- single circuit tech columns **03**
- dual circuit tech columns **03**
- panel connecting brackets **04**
- freestanding base **06**
- lettrix softwiring system **06**
- product specification **07**

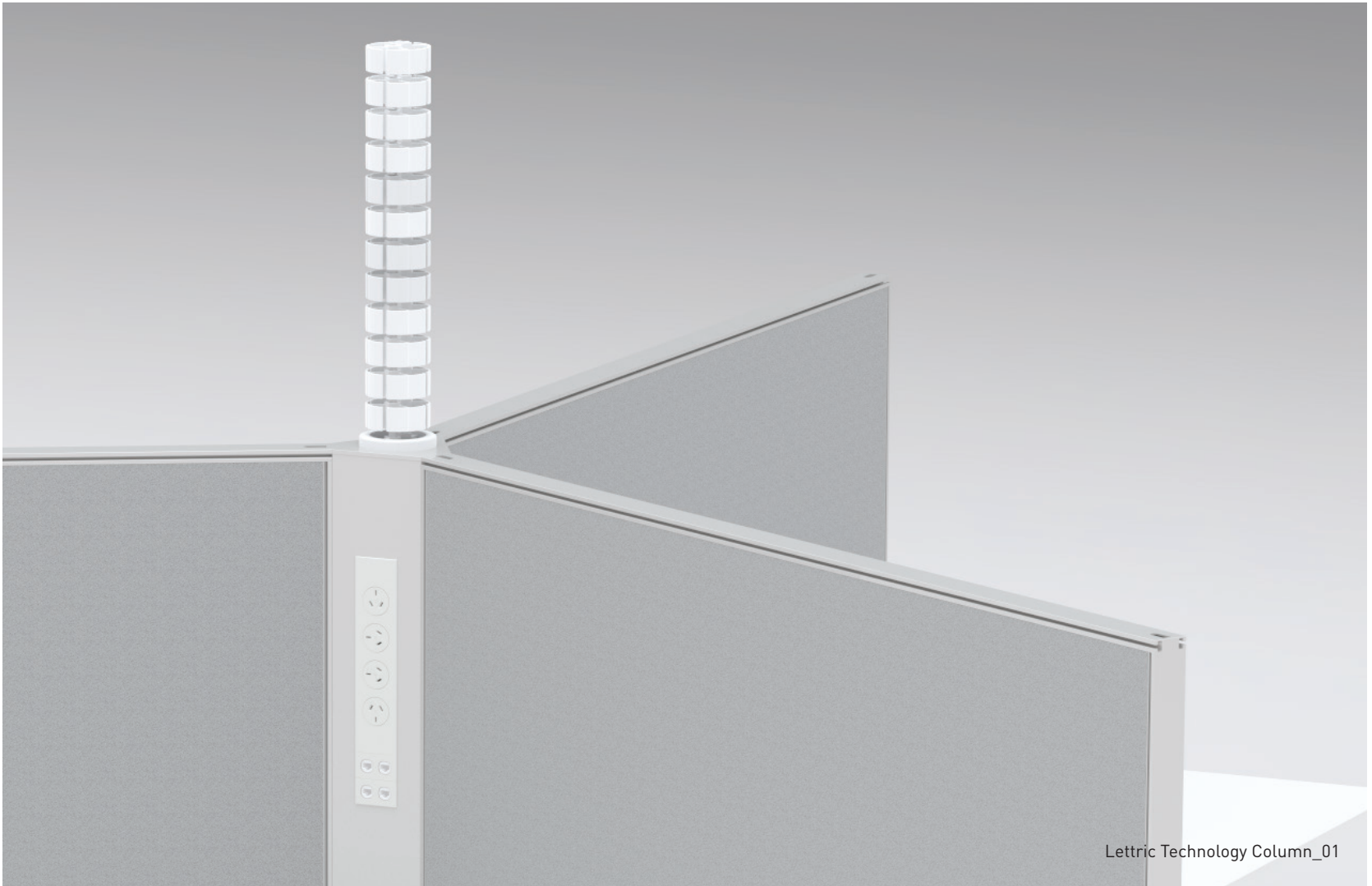

120° lettric technology column

workstation clusters | panel to tech column junction options

The 120° Lettric Technology Column has been designed to integrate with the System 30, System 45 and E45 panels as well as freestanding applications. Cables can be reticulated from the ceiling via a standard Schiavello Umbilical or Cylinder Power Pole or atrnatively from the floor through the base of the column. For larger clusters cable can also be reticulated from Tech Column to Tech Column by using panel mounted cable reticulation trays.

Panels connect to each corner recess of the Tech Column via attaching brackets, forming 3 way 120° workstation clusters.

Freestanding applications are achieved with the addition of a circular metal base.

TYPICAL 120° 3-WORKSTATION CLUSTER

Using system 30, system 45 or E45 panels with 2 Tech Column

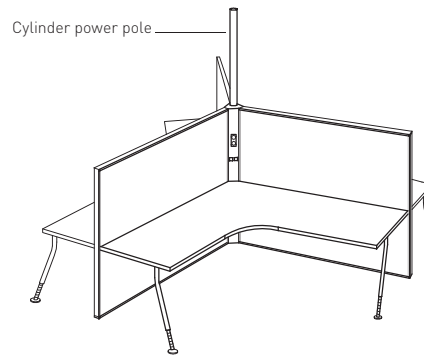
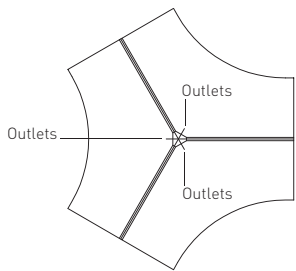

TYPICAL 120° 6-WORKSTATION CLUSTER

Using system 30, system 45 or E45 panels with 2 Tech Columns

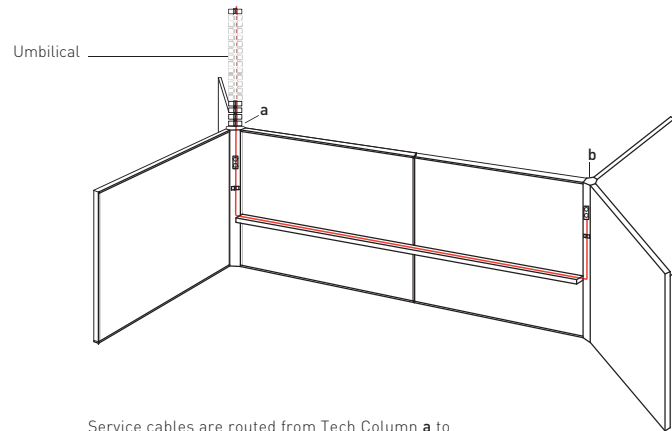
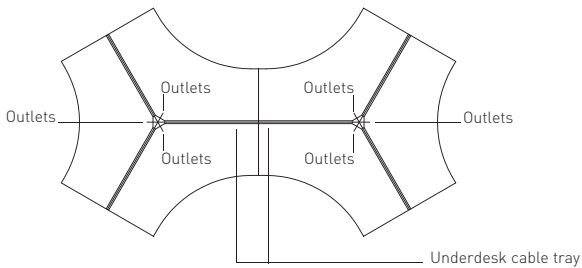

Service cables are routed from Tech Column **a** to Tech Column **b** via either an underdesk cable tray attached to the panel or through the E45 duct channel.

PANEL TO TECH COLUMN JUNCTION OPTIONS

By use of the appropriate panel connecting brackets System 30, System 45 or E45 panels can be attached to the verticals at each corner of the Tech Column. They can be positioned at any height on the vertical allowing junctions of common height, transition height or panels suspended from the floor.

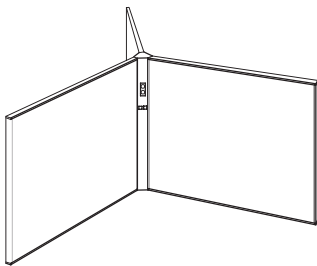

common height panels

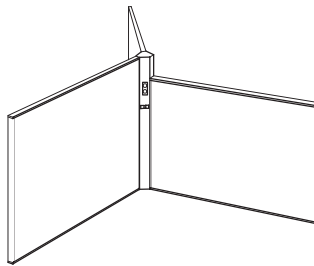

transition height panels

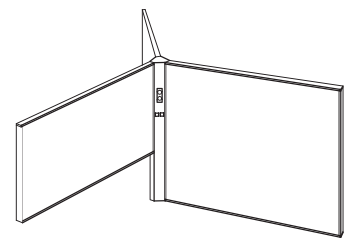

suspended and floor standing panels

120° lettric technology column

suspended tech columns | single circuit columns | dual circuit tech columns

SUSPENDED TECH COLUMNS

Shown starting 300 mm above floor, 400 mm also available upon request.

Optional single exit/entry for tech column to tech column application

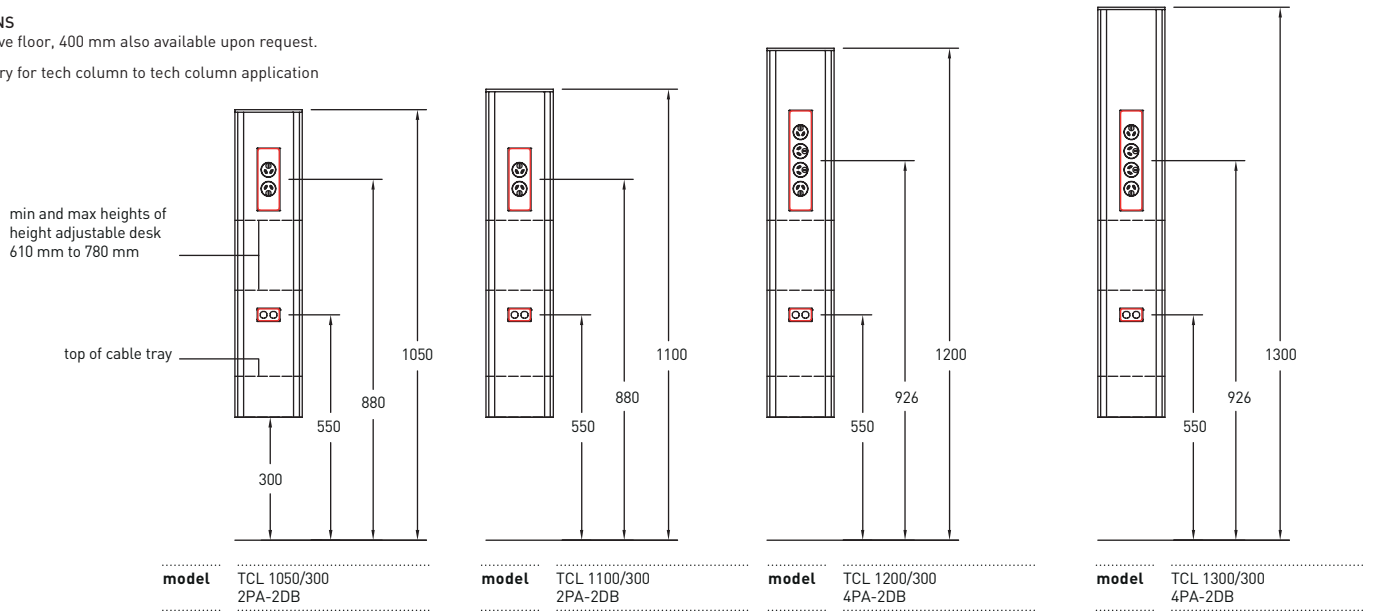

SINGLE CIRCUIT TECH COLUMNS

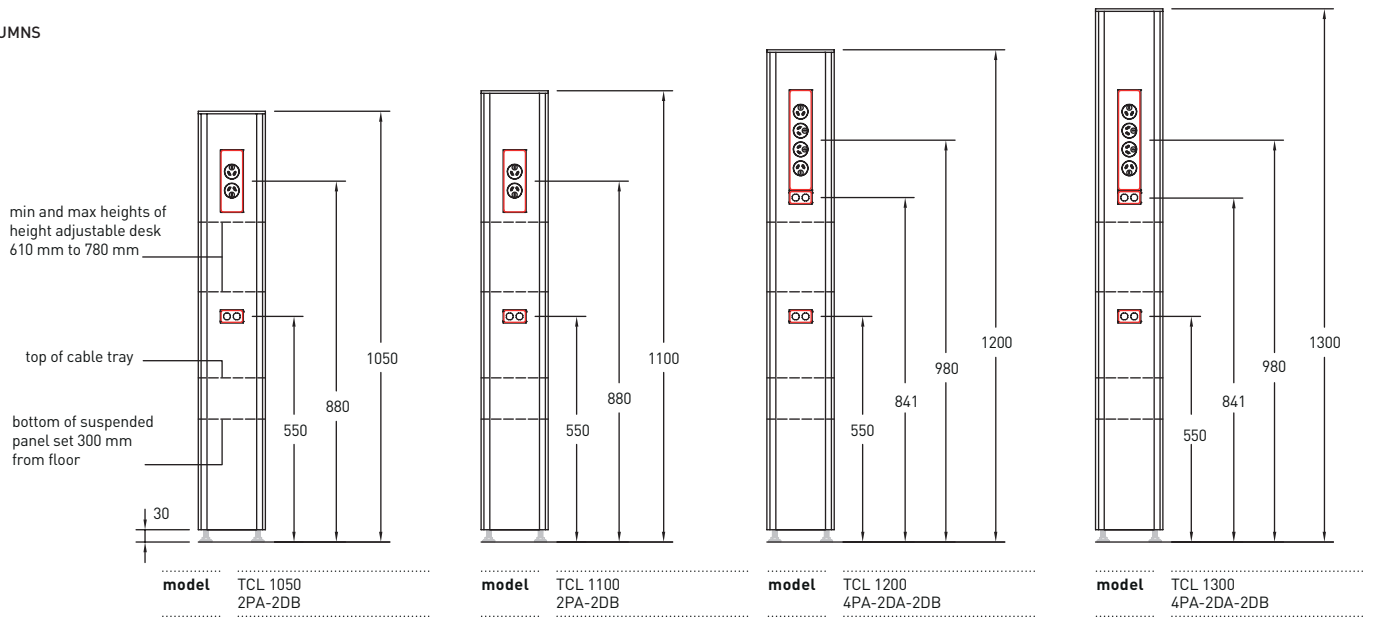

DUAL CIRCUIT TECH COLUMNS

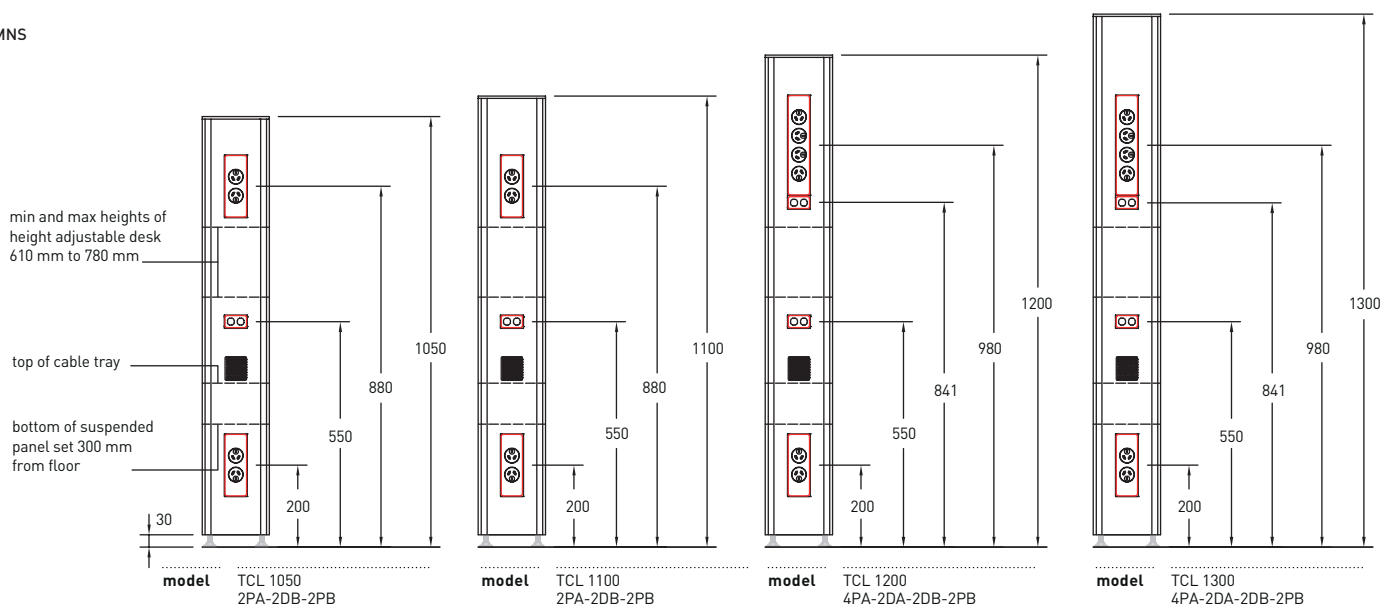

120° lettric technology column

panel connecting brackets E45 | system 30 | system 45

PANEL CONNECTING BRACKETS - E45

code E45.LTC

- a_1-type lettric technology column
 - main extrusion - P12854
 - spreader extrusion - 017225
 - removable cover - 017224
- b_1-type top cap
 - (Select type a or b)
 - type a_A4010006
 - type b_A4010008
- c_3-type WS1B-E45 connector
- d_3-type E45JFC foot casting

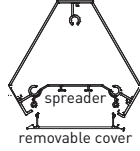

a

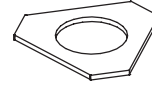

b type a
with umbilical/power
pole access hole

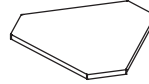

b type b
solid

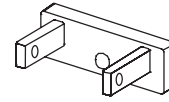

c
E45 wallstarter

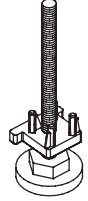

d

PANEL CONNECTING BRACKETS - SYSTEM 30

code S30.LTC

- a_1-type lettric technology column
 - main extrusion - P12854
 - spreader extrusion - 017225
 - removable cover - 017224
- b_1-type top cap
 - (Select type a or b)
 - type a_A4010006
 - type b_A4010008
- c_6-type WS1B-30 connector

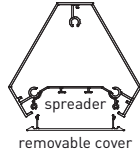

a

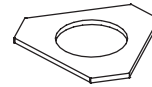

b type a
with umbilical/power
pole access hole

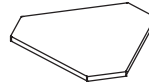

b type b
solid

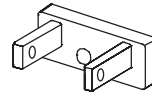

c
System 30 wallstarter

PANEL CONNECTING BRACKETS - SYSTEM 45

code S45.LTC

- a_1-type lettric technology column
 - main extrusion - P12854
 - spreader extrusion - 017225
 - removable cover - 017224
- b_1-type top cap
 - (Select type a or b)
 - type a_A4010006
 - type b_A4010008
- c_6-type WS1B-45 connector

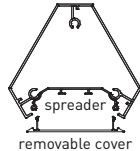

a

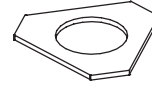

b type a
with umbilical/power
pole access hole

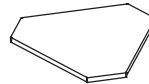

b type b
solid

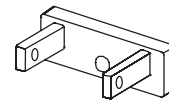

c
System 45 wallstarter

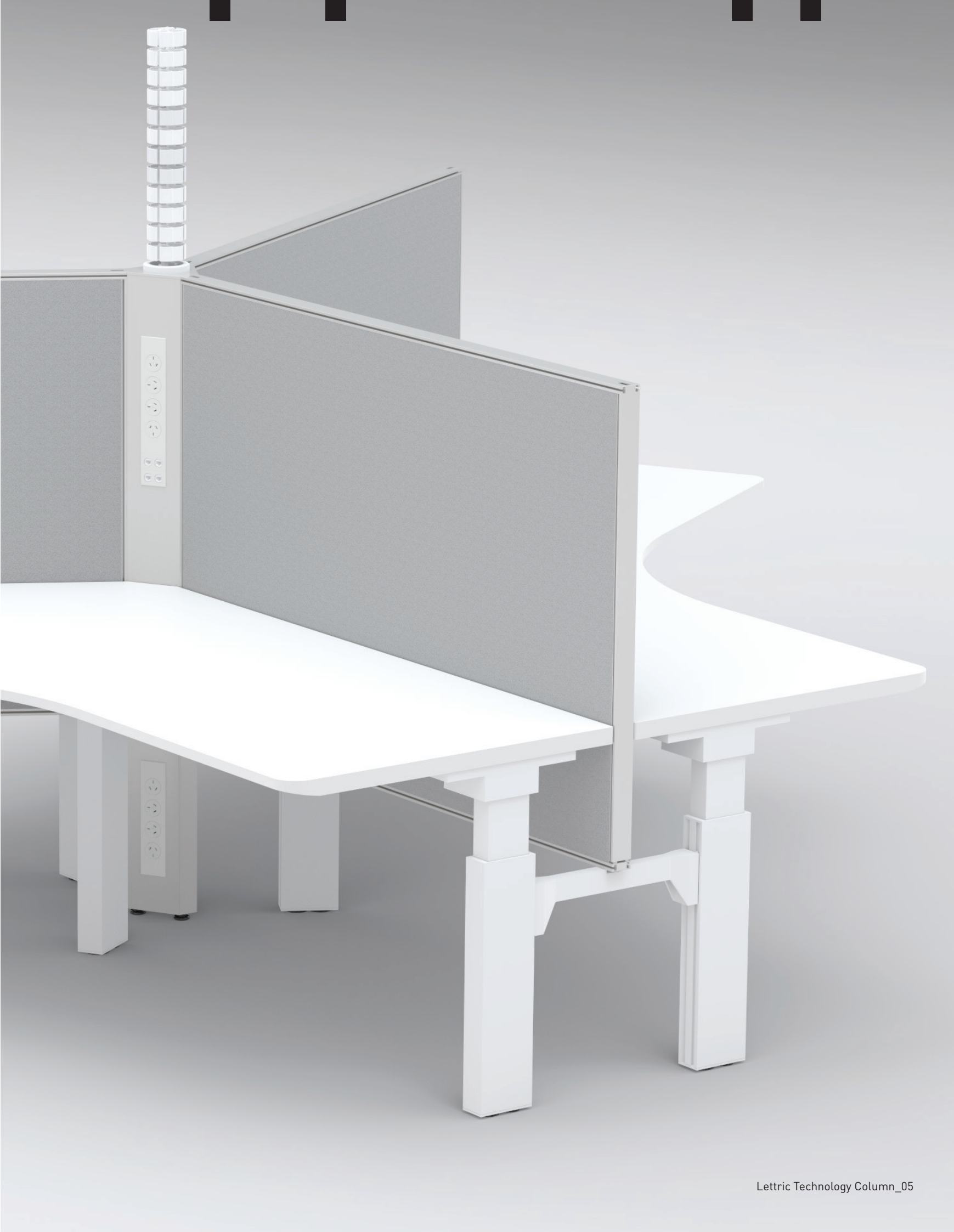

120° lettric technology column

freestanding base | lettric softwiring system

FREESTANDING BASE

Attaches to bottom of Tech Column providing a stable base in lieu of connecting panels. 450 mm diam. steel plate construction

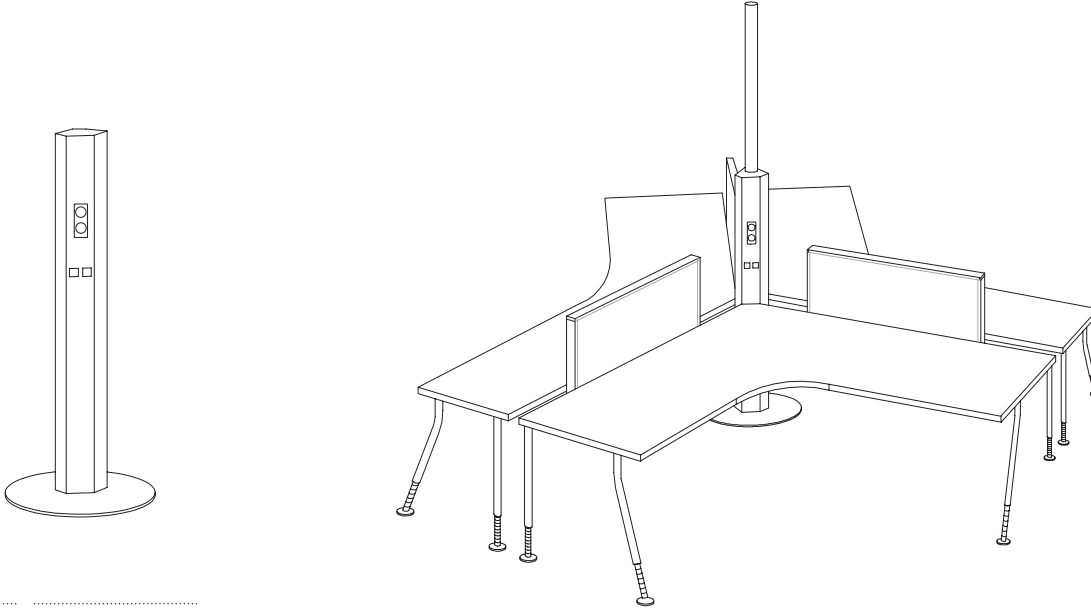

code TC-FSB-450

Freestanding base

LETTRIC SOFTWIRING SYSTEM

Schiavello softwiring system delivers power and lighting to workstations. The system is easily connected, disconnected or relocated without the need to isolate power and with minimal inconvenience. All connections within systems are protected by a positive lock mechanism to prevent accidental power disconnection.

There are numerous outlet combinations available for each option. Refer to Schiavello Lettric brochure SCH/LE01-A for complete product information and technical specification.

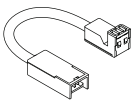

code LEC-EX-AS

Installation Lead
Right Angle Socket

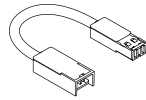

code LEC-EX

Installation Lead

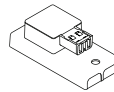

code LEC-SS

Starter Socket



code LEC-TP

Tee - Plug



code LEC-JB

Junction Box

FACE MOUNTED POWER MODULES

Note: See the Lettric Brochure for the full range of Lettric softwiring products.

DATA TILES

BLANK TILES

UMBILICAL

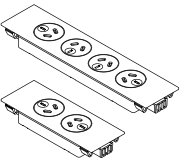

code LEC-PM2R-FM
LEC-PM4R-FM

Dual Power Module_Face Mounted Rotated
Quad Power Module_Face Mounted Rotated

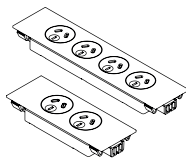

code LEC-PM2-FM
LEC-PM4-FM

Dual Power Module_Face Mounted Vertical
Quad Power Module_Face Mounted Vertical

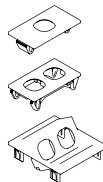

code LEC-D1
LEC-D2
LEC-D2-AF

Tile_Single Data
Tile_Two Data
Tile_Two Data_Angled Face

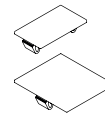

code LEC-BL
LEC-BL-DBL

Tile Blank Single
Tile Blank Double



code UMB

Umbilical

Specification of 120° lettric technology column

general | cable reticulation | aluminium finish | warranty

General

The 120° Lettric Technology Column with Lettric Softwiring is manufactured by Schiavello Australia.

The column has a high rigidity construction with sufficient strength and means to connect and support workstation panels, types System 30, System 45 and E45. Panels can be of common height, transition heights, floor standing or suspended. Adjustable floor leveling feet are an integral component of the design as is the ability of the column to freestand when fitted with the optional flat plate base for non panel connected applications.

Cable Reticulation

The system includes integrated components that provide efficient means of routing services cabling to the Technology Column from the ceiling, walls or floor. Such as umbilicals or power poles. The column is of sufficient dimension to accommodate power and data service cables and outlets for three workstations with either single or dual power circuits. The column has a removable face allowing easy set-up and service access. The softwiring electrical system is Schiavello Lettric certified AS/NZS 3131. The column is suitable for data cables up to and including cat 5e, cat 6, cat 6a and cat 7. (The particular data sockets intended for use with cat 6a and cat 7 should be advised at time of order).

Aluminium Finish

All aluminium is powdercoated to Australian standard AS/NZS 3570. Colour as specified.

Warranty

The Lettric Technology Column is covered by a 5 year warranty against faulty materials and workmanship that includes a guarantee to support parts of all standard components and service for a period of not less than 10 years from date of installation.



Melbourne Head Office

Schiavello (Vic) Pty Ltd
1 Sharps Road
Tullamarine VIC Australia 3043
T: 61) 3 9330 8888
F: 61) 3 9330 8899

Melbourne Showroom

Schiavello (Vic) Pty Ltd
Metropol
8 Whiteman Street
Southbank VIC Australia 3006
T: 61) 3 9674 1500
F: 61) 3 9674 1650

Adelaide

Schiavello (SA) Pty Ltd
Ground Floor, 101 Currie Street
Adelaide SA Australia 5000
T: 08) 8112 2300
F: 08) 8231 1419

Brisbane

Schiavello (Qld) Pty Ltd
265 Coronation Drive
Milton QLD Australia 4064
T: 07) 3368 3388
F: 07) 3876 2130

Canberra

Schiavello (ACT) Pty Ltd
2-6 Collie Street
Fyshwick ACT Australia 2609
T: 02) 6124 0500
F: 02) 6280 4370

Perth

Schiavello (WA) Pty Ltd
1315 Hay Street
West Perth WA Australia 6005
T: 08) 9420 6588
F: 08) 9322 1337

Sydney

Schiavello (NSW) Pty Ltd
69 Campbell Street
Surry Hills NSW Australia 2010
T: 02) 9211 3311
F: 02) 9212 3788

Singapore

Schiavello Singapore Pte Ltd
No.1 Magazine Road
#01-05 Central Mall
Singapore 059567
T: 65) 6533 8011
F: 65) 6533 2811

schiavello.com/technologycolumn

SCH/TEC02-A

Schiavello Group Pty Ltd
reserves the right to change
any or all details without
prior notice. All dimensions
stated within this document
are nominal and/or approximate
only and subject to variation.

schiavello